

Warranty Policy

Limited Warranty

1. All Teletronics products have 1 Year Warranty Period. (Except List of Antennas Attached)
2. Our Warranty Period does not cover physical damages, misuse of the product, and natural disasters.
3. International customers have 60 business days return policy, in order to receive full refund for the items purchased. Only if the item is consider to be brand new unit. (Unopened Items)
4. Domestic customers have 30 business days return policy, in order to receive full refund for the items purchased. Only if the item is consider to be brand new unit. (Unopened Items)
5. Within the 30/60 business days, for all used items, there will be a restocking fee charge (0-45%). Depending on the condition of the item. Restocking Fee might vary.
6. All original materials must be returned in good resalable condition.
7. No refund, exchange or full credit will be issued after the 30/60 business day return policy.
8. Out-of-Warranty items are repaired or replaced only with the customer's prior approval. Labor charges and freight will vary based on the condition of defective item.
9. Advanced Replacement Cases, must be issued within the 1 Year Warranty Period
10. All RMA numbers automatically expire 30 days after date of issuance.
11. Teletronics reserves the right to refuse any RMA shipment that does not come with RMA Case Number or an invalid RMA Case Number.

Terms & Conditions

1. REPAIR WARRANTY: All warranties are void if Teletronics finds that the product has been abused, physically damaged or altered in any way without prior written authorization. **2. OUT OF WARRANTY PRODUCT:** Out-of-Warranty Products are repaired only with the customer's prior approval. For Out-of-Warranty repair charges, please contact us at 301.309.8500 x136 or rma@teletronics.com. **3. PACKAGING:** Please clearly mark the RMA number on the outside of the packaging. Damage or loss of goods during shipment is the sole responsibility of the customer. Product must be returned in original carton or in packaging of equal or greater quality. **4. RMA NUMBER:** Any returned product without a valid RMA number or no RMA number will be refused and returned to the sender. RMA numbers are only valid for 30 days from the date they are issued. Please write the RMA number on the box in bold letters using permanent marker on at least two different sides of the box. **5. PRODUCT:** Ship only the product(s) specified on the original RMA request and includes any additional items. Any additional products will require a new RMA number. **6. SHIPPING COST:** The customer is responsible for the cost of shipment to Teletronics and we will be responsible for the cost of shipment back to the customer. Ship to: Teletronics International, Inc. 2 Choke Cherry Road, Suite 100 Rockville, MD 20850 USA. **7. SHIPPING METHOD:** All the repaired products will be shipping back to customers via UPS/FedEX Ground service. For International customers via Economic **8. ADVANCED REPLACEMENT:** If you are requesting Advanced Replacement for the defective product, you must provide us with a valid credit card number as a guarantee. Please Note: Advanced Replacement charges will be applied to the customer's credit card, if the defective product is not received by Teletronics within 21 business days. **9. RMA REFUND:** Customer is required to provide the original invoice/receipt to request RMA credit.

6 Easy Steps to Receive an RMA Case#

1. Go to: <http://www.teletronics.com/RMA.html>
2. Download the RMA Form; fill it out the entire fields with the appropriate product information
3. Email the word file to rma@teletronics.com
4. Within 1 Business Day, you will receive an email with the RMA Receipt Confirmation
5. Package the defective unit with the suitable material
6. Identify the outside of the box with the RMA Case # given in the RMA Receipt
7. Ship the package to: Teletronics – RMA Dept 2 Choke Cherry Rd, Suite 100. Rockville, MD – 20850 USA

NOTE: Advanced Replacement Cases must be issued before 4:30pm (Eastern Time), in order to ship the package the same business day.

*Specifications Subject to Change without Prior Notice!

All Rights Reserved. Copyright 2006 Teletronics International, Inc.
2 Choke Cherry Road, Rockville, MD 20850 Tel: 301.309.8500 Fax: 301.309.8851



TT™ 4900
IEEE 802.11a
4.9GHz

Quick Product Guide

Product Specifications:

CPU: Ubicom IP3023
Radio: Atheros 802.11a

Mechanical Specifications:

Chassis Dimension (W x D x L): 200mm x 70mm x 120mm
7.87" x 2.75" x 4.7"

Board Specifications:

Network Standard: IEEE 802.11a, IEEE 802.3, IEEE802.3x
Ethernet: 10/100BaseT Ethernet, Auto MDI/MDI-X
Network Architecture Infrastructure: Ad-Hoc, MAC, CSMA/CA
Status Indicators: Power, Wireless LAN, Ethernet LAN, and RSSI
Push Button: Reset to Default Button

Radio Specifications:

IEEE 802.11a 5GHz Mini PCI Card
Specification Description: Chipset MAC/BB
Processor Atheros AR5213 RF Chip Atheros AR5414A
Power Consumption: Tx: ~1000mA Rx: ~400mA
Antenna Connector: N-type Female
Output Power: 23 dBm (+/- 1.5dB) @ 6/9/12/18/24 Mbps
(200mW) 22 dBm @ 36 Mbps
21 dBm @ 48 Mbps
18 dBm @ 54 Mbps

Receiver Sensitivity: -90 dBm @ 6 Mbps
-72 dBm @ 54 Mbps

RF Channels: Total of 12 Non-Overlapping Channels
(4 Channels: 5.725 ~ 5.850 GHz)
Data Security: WPA/WPA2, 64/128 bit WEP
Fully Transparent Bridge: Unlimited MACs
Management: Web and SNMP based Management

DC Power Input: Includes 48VDC Adapter and PoE
Injector with surge protection, IEEE 802.3af compliant

Frequency Band: 4.950, 4.960, 4.970 GHz
Operating Environment: -40 °C to + 70 °C
Enclosure: Silver Powder Coated Cast Aluminum



TT™4900 FEATURES

- Ultra High 500mW Output power in OFDM modulation (w/optional M58 Amplifier)
- Web & SNMP based Management
- Transparent bridging supports unlimited MACs
- WPA/WPA2 & 64/128 bit WEP Data Security
- 5 Ultra-bright LEDs indicating RSSI
- Ruggedized Waterproof & All-Weather Enclosure

Package List

1. TT™4900 802.11a PCBA (1)
2. IEEE 802.11a Mini PCI Card (1)
3. Power Over Ethernet Injector (1)
4. 48VDC Power Adapter (1)
5. Ethernet Cable (2)
6. Waterproof RJ-45 Connector (1)
7. Mounting Hardware (1)
8. Quick User Guide

Assembly Instruction

I. Assembly Diagram

*Actual parts may vary, please use this diagram for general guidance.

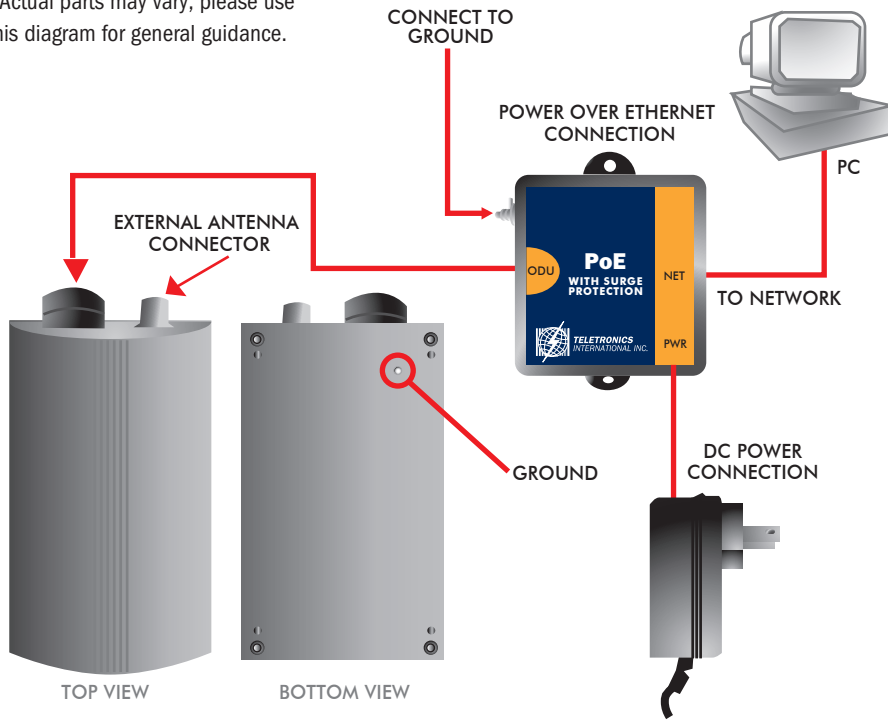

Quick Installation

Always double check for any missing parts before deployment. Next step is to set up the computer Ethernet interface for configuring the TTTM4900. Since the default IP Address of the unit is on the 192.168.10.x IP range in both Client Bridge and AP mode you'll need to set the computer Ethernet interface within the same IP range, such as 192.168.10.66.

Web Control Interface

Default IP Address in Client Bridge Mode (SU): **192.168.10.241**

<http://192.168.10.241/>

Default IP Address in Access Point Mode (AP): **192.168.10.240**

<http://192.168.10.240/>

Default Login/Password: Nothing needs to be typed in for login and password authentication.

For detailed instructions on how to configure the TTTM4900, please refer to www.teletronics.com/Support.html

Hardware Installation

Follow the procedure below to install your TTTM4900 device:

1. Select a suitable place on the network to install the TTTM4900. For best wireless reception and performance the external antenna should be positioned within Line of Sight from the AP with proper alignment.
2. Connect the TTTM4900 to the ODU side of the PoE Injector via a straight Ethernet cable (Cat-5), then connect the NET side of the PoE Injector to either a computer or an Ethernet Switch.

Note: The TTTM4900 now supports MDI/MDI-X and no longer require the use of cross over cable to connect directly with a computer.

3. Connect the 48VDC power adapter to the power jack on the PoE injector to power on the TTTM4900.

Check the LEDs on the TTTM4900 to confirm if the status is okay. At this point the PWR and LAN LEDs should be on green. The WLAN light should light up once the unit is associated wirelessly with another wireless device. However at this point the unit is still in factory default setting so do not be alarmed that the WLAN light doesn't light up.

Waterproof RJ-45 Connector Assembly

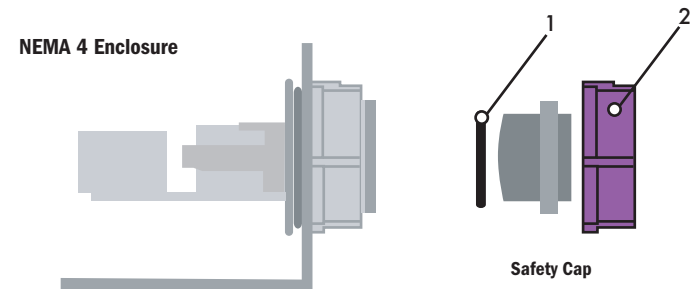

Re-using items (1) and (2) from the safety cap, assemble the waterproof RJ-45 connector as shown below:

